

Foundation panel installation instructions

Kerabit Foundation Panel

Preparations

The foundation wall and drainage are created in accordance with the valid regulations. Lightweight aggregate concrete block foundations must be wet dashed. The joint between the foundation wall and the footing must be made gentler (e.g. mortar or Kerabit Bitumen cove strip).

Irregularities and cracks in the foundation wall must be repaired and the wall brushed clean before installing the foundation panel. In the event of renovation, remove any irons and mortar sticking out from the foundation wall. After this, wash the foundation wall with warm water using a street brush and allow it to dry until the surface no longer feels wet. Mark the location of the top edge of the foundation panel with a coloured thread approx. 5 cm below the future ground surface level, and install the bottom edge down to the bend in the footing. Always ensure safety when working!

Materials

- Kerabit BIL 20/85 Primer
- Kerabit Pato/Radon Strip (torch-on bitumen membrane) or Platon Self-Adhesive Membrane
- Kerabit Foundation Panel
- Kerabit Edge Trim
- Baros Plug Nails 3 x 60 mm for lightweight blocks, Baros Plug Nails 5 x 45 mm for a concrete base or Kerabit Fasteners 6 x 40 mm for a concrete base
- fasteners for fastening the edge trim (alternatively, for example, Ø 5 x mm 40 mm aluminium nail anchors for a concrete base and plug nails with the plugs removed for lightweight aggregate concrete blocks)

Tools

- bitumen brush
- street brush
- liquefied gas torch
- hammer
- carpet knife
- scissors
- hand saw
- tape measure
- coloured thread
- for a concrete base, a drill and Ø 5 or Ø 6 mm bit, depending on the fastener



1. Carefully mix the Kerabit BIL 20/85 Bitumen Primer and then apply it to the area to be covered by the Pato/Radon Strip or Platon Self-Adhesive Membrane. Apply the primer to the front of the footing and on the foundation wall to a height of at least 50 cm with one crosswise spreading, consumption approx. 0.1–0.2 l/m². The primer must be allowed to dry completely, which takes about two hours in normal conditions.

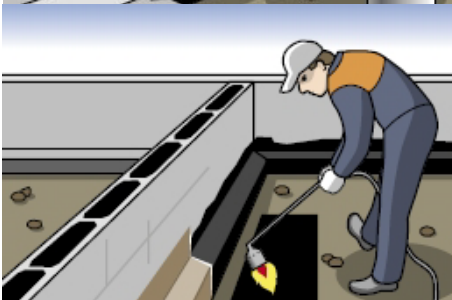

2. Cut pieces of the Pato/Radon Strip about two metres in length and install them such that they cover the footing approx. 5–10 cm down from the top edge of the footing. Place the piece next to the footing with the backside up, and heat its bottom section using the liquefied gas torch. The heating is sufficient when the plastic on the back has melted and the bitumen is melted and bubbly. Avoid excessive heating so that the membrane is not damaged.

Note: The hot bitumen membrane strip must be handled

with care, not allowing it to come into contact with the skin!

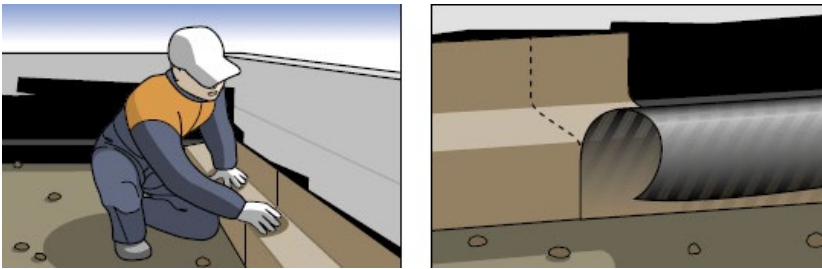

3. Press the strip onto the foundation wall immediately after heating. After this, lower the top section of the strip, heat it and press it on ensuring that it is fully fastened to the wall. At splices, overlap the strips by approx. 10 cm.

(Alternatively, you can use Platon Self-Adhesive Membrane. The outdoor temperature must be at least +10 °C when installing it. First fasten the top edge of the membrane and carefully remove the protective film by pulling it down. Carefully press all over the membrane to fasten it to the base.)



4. At an outside corner, cut a corner piece 30 cm wide and install it as shown. Place the next strip onto the corner piece and fold it as shown. Cut a V-notch in the strip as shown in the middle figure to facilitate the installation of the membrane. Start installing the next strip from the corner.

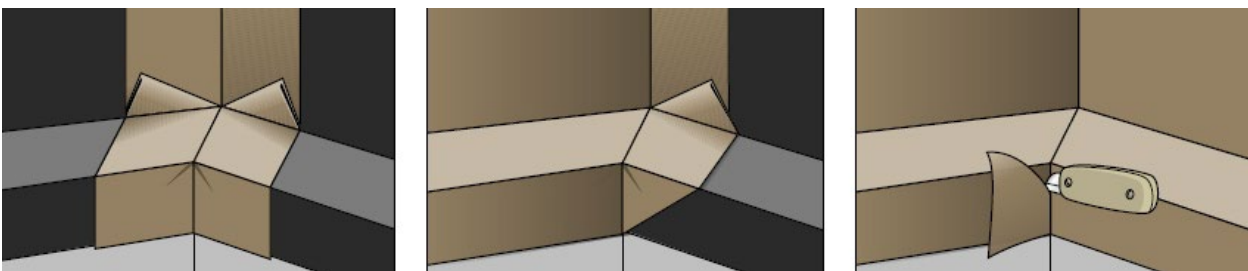

5. At an inside corner, cut a corner piece 30 cm wide and install it as shown. Place the next strip onto the corner piece and fold it as shown. Start installing the next strip from the corner. Cut off the excess.



6. Cut the foundation panel to the correct height. You can cut the roll with a hand saw to make it narrower. Individual cuts are made using scissors or a carpet knife. When installing the panel, ensure that it is the right way round, with the studs against the foundation wall. This way, an air gap is left between the panel and the foundation.

The foundation panel can be folded across a corner. The easiest way to manage the corner of the foundation wall is to start the installation about 1.5 metres away from the corner.

The overlap of the foundation panel must be at least 12 cm for horizontal joints and at least 50 cm for vertical joints.

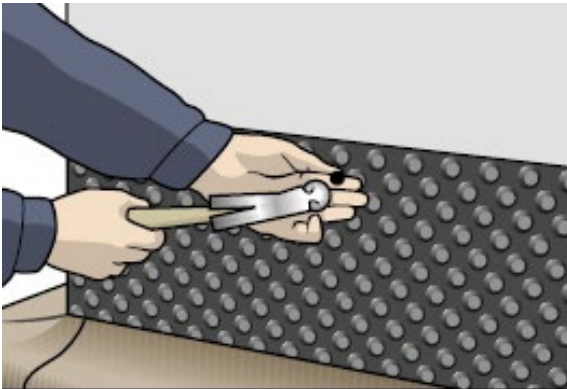

7. Fasten the top edge of the foundation panel with plug nails or fasteners at 25 cm intervals. The plate is finally set against the foundation wall by the weight of the soil.

For lightweight aggregate concrete blocks, use Baros Plug Nails 3 x 60 mm. When fastening to a concrete wall, use Baros Plug Nails 5 x 45 mm (pre-drilled holes Ø 5 mm) or Kerabit Fasteners 6 x 40 mm (pre-drilled holes Ø 6 mm).

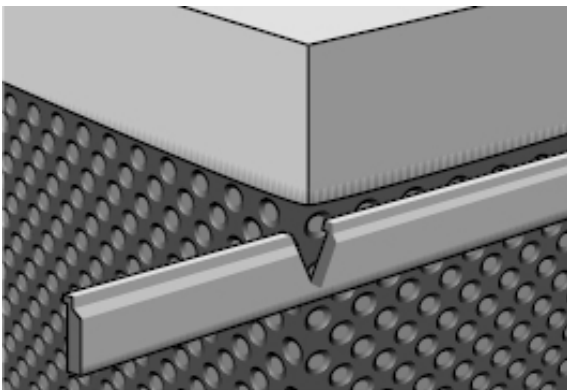

8. Place the Kerabit Edge Trim onto the top edge of the foundation panel and fasten at the holes. For a concrete base, you can use Kerabit fasteners or, for example, Ø 5 mm x 40 mm aluminium nail anchors. For lightweight aggregate concrete blocks, use plug nails with the plugs removed. At corners, cut a V-notch at the top edge of the edge trim and fold the trim over the corner.

Plaster the part of the foundation wall above the edge trim down to the trim.



9. The functionality of the structure must be ensured using the appropriate filling material, drainage and ground surface gradients away from the building.

Foundation panels must be covered as soon as possible to prevent damage during construction. They must be covered carefully so that they are not damaged. **The panel and edge trims must remain below the ground surface.**

30 March 2022